

1. Verify connectivity to eduroam.
  - a. Note: Connect to eduroam with your UMB student login (UMID@umaryland.edu)

2. Open File Explorer  and click into the address bar (see screenshot).
  - a. Type: <\\law-clinicprint.law.umaryland.edu>
  - b. Click “Enter”. If prompted for a username/password enter in your full *clinic* email address/password and click “OK”
  - c. The list of available printers will then display

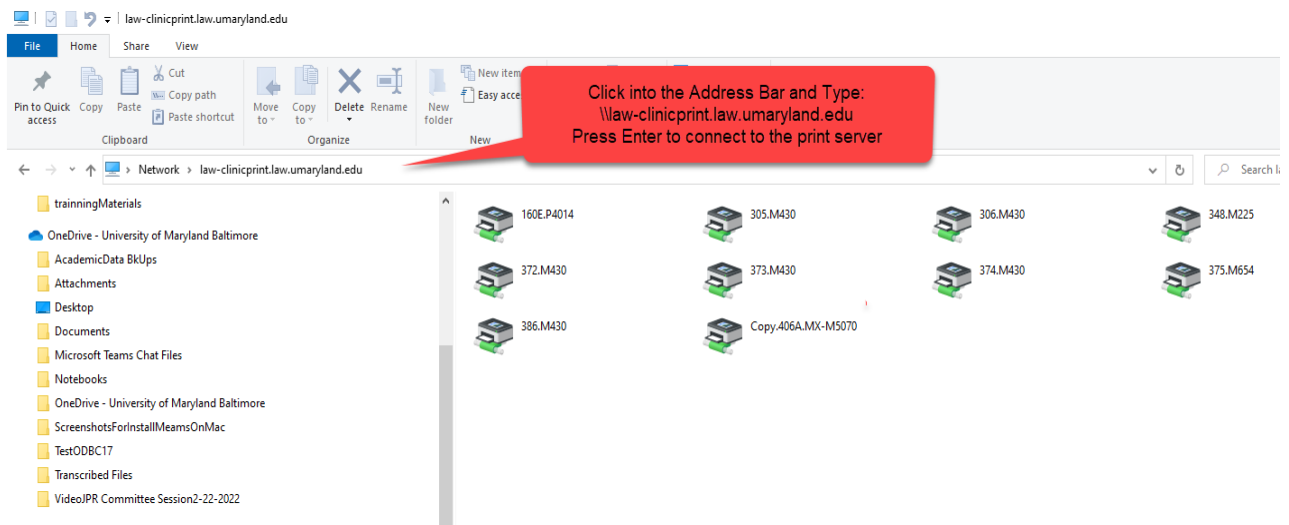

3. Right click the desired printer and click “Connect”. The first 3 digits of the printer’s name is the practice office room number, e.g., if you are in room 305, choose the printer 305.M430.
  - a. If prompted for a username/password enter in your full *clinic* email address (UMID@clinic.law.umaryland.edu)/password, check the box “Remember my password” and click “OK”
  - b. If driver will not download check wireless connection and ensure you’re connected via a UMB Student account

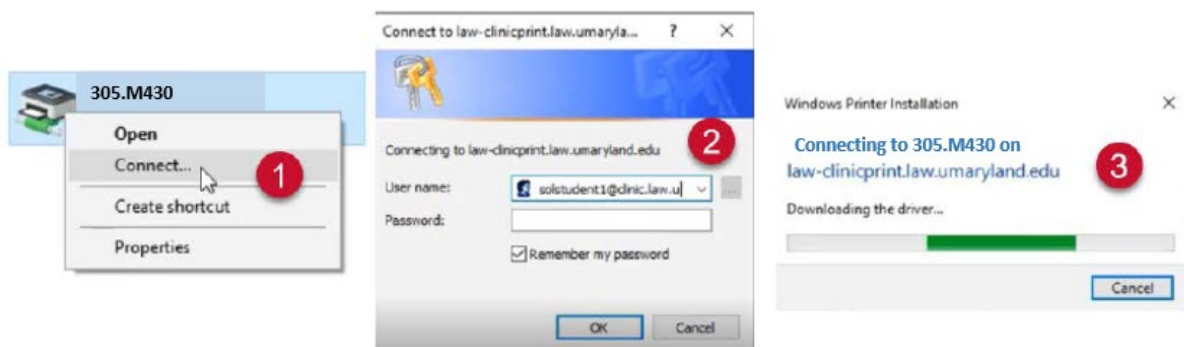

#### 4. Open document and print.

The screenshot shows the Microsoft Word Print dialog box for a document named "Document1 - Word". The "Print" button is visible with a "Copies" dropdown set to 1. A red callout box with the text "Choose the Printer and click on Print" points to the printer selection dropdown menu. The dropdown menu is open, showing a list of printers. The printer "305.M430 on law-clinicprint.law.umaryland.edu" is selected and highlighted. Other printers in the list include "372.P4014 on law-clinicprint.law.umaryland.edu" (Status Unavailable), "373.P4014 on Law-ClinicPrint.law.umaryland.edu" (Status Unavailable), "374.P4014 on law-clinicprint.law.umaryland.edu" (Status Unavailable), "305.P4014 on law-clinicprint" (Status Unavailable), "Go2.Color on law-pay4print" (Ready), "361.P4014 on Law-Print19.law.umaryland.edu" (Status Unavailable), "4401F.M428 on Law-Print19.law.umaryland.edu" (Ready), "461.M404 on Law-Print19.law.umaryland.edu" (Ready), "Copy.375\_LMX-6070.Color on Law-Print19.law.umaryland.edu" (Ready), "343.M608 on law-print19" (Ready: 2 documents waiting), "348.M225 on law-print19" (Ready), and "367.M404 on law-print19" (Ready). The "Add Printer..." link is visible at the bottom of the printer list. The main document area on the right contains the text "Print test".